

# HINES HALL

I.S.O. 2014

FLOOR: \_\_\_\_\_

(2-10)

S  
E + W  
N

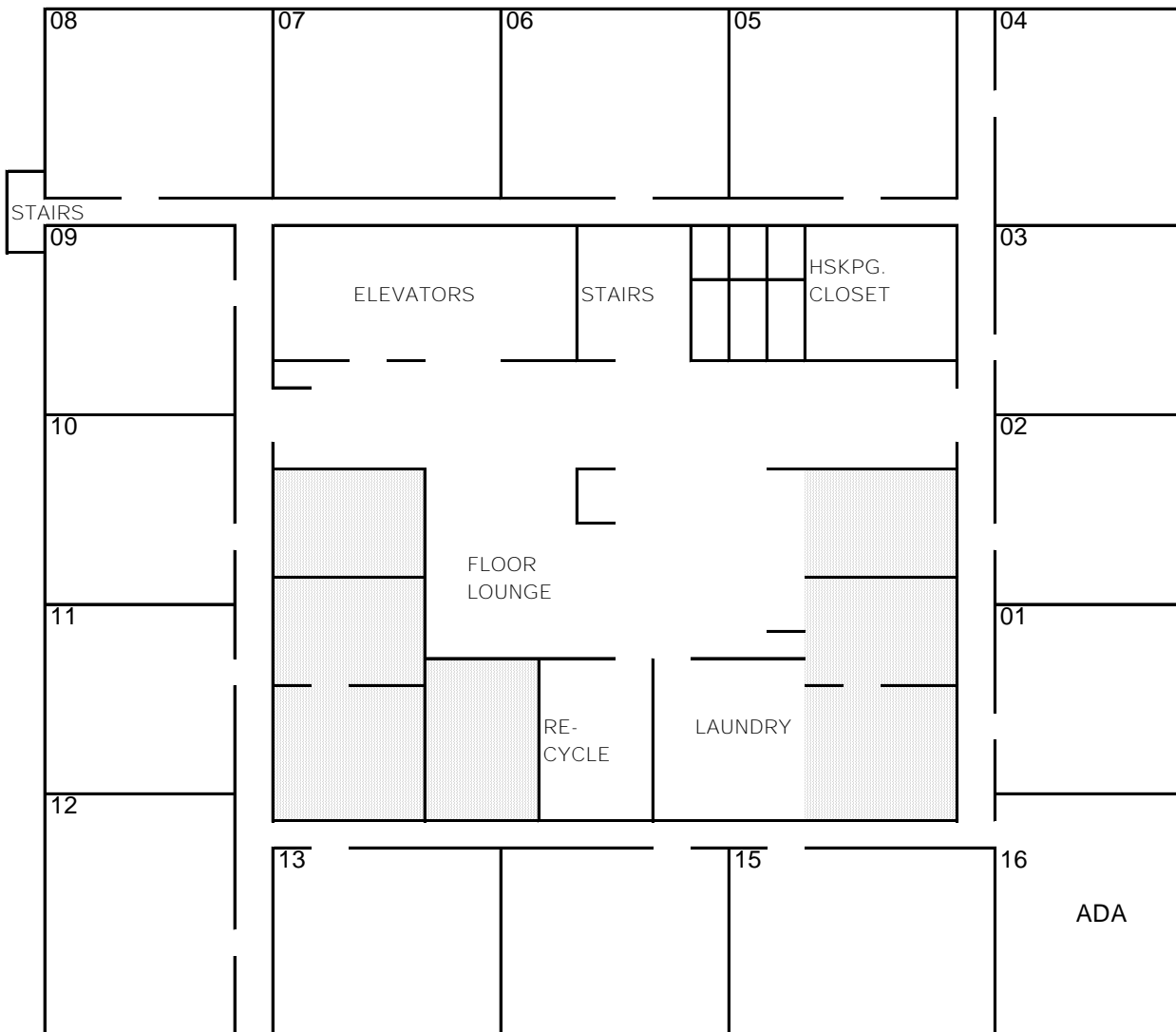

\* NOTE: The "16" room on floors 2 thru 9 are ADA accessible. Rooms 516 and 916 have roll-in shower units.

\*\* NOTE: The "15" and "16" rooms on the 10th floor are the Assistant Director's apartment. DO NOT include these rooms when making conference housing assignments.